



EV系列熔断器产品，
是应用于新能源电动汽车领域，
为电器控制盒、充电设施等
提供稳定可靠的安全电气保护。
产品符合日本工业汽车协会熔断器标准
JASO D6222。

The EV FUSE Product series,are applied to
new energy EV(electric Vehicles)field,which can
provide stable and reliable electric safety protection
for BDU(Battery Disconnect Unit) / MSC(Maintenance
Safety Disconnect) and charging facilities.
Product meets the standard of JASO D6222.



Mingrong was located in Wenzhou city of Zhejiang province in China. As one of the earliest professional manufacturers of fuse and electrical protection in China, Company employs 450 staffs, and covers an area of 12000m².

茗熔位于中国浙江省温州市。作为中国最早从事熔断器及电器保护系统的专业生产厂家之一，公司现有职工450名，占地面积12000m²。

Mingrong also brings in the domestic and foreign advanced professional manufacturing equipment, automation equipment, and inspection equipment. There are more than 600 sets of equipment, of which 38 sets of large equipment.

茗熔还引进国内外先进的专业生产制造设备、自动化设备、检测设备。现有设备600余台/套，其中大型设备38套。

With over 30 years of fuse manufacturing experience and continuous innovation, Mingrong have gained excellent reputation from customers both in the domestic and the overseas markets.

秉承三十余年的制造经验及持续创新，茗熔赢得国内外顾客的高度评价。

MINGRONG
ELECTRICAL PROTECTION

400 800 9662
服务热线 Service hotline

地址:浙江省乐清经济开发区纬十一路 325600
Add:Wei 11th Road, Economic Development Zone, Yueqing Zhejiang 325600 China
电话(Tel): +86 577 6266 8831/8810 传真(Fax):+86 577 6266 8833
E-mail:info@mingrongep.com Crystal.cai@mingrongep.com
Http://www.mingrong.com

基本数据 Basic Data

该系列直流(DC)熔断器产品,目前有两个电压等级:DC110V与DC500V。产品执行标准:低压熔断器标准GB13539.1与GB13539.4,及日本工业协会汽车熔断器标准JASO D6222。

This series of direct current (DC) fuse products, There are two voltage levels: DC110V and DC500V. Product standards: Low voltage fuse standards GB13539.1 and GB13539.4, JAMA in JASO D6222.

◆直流DC110V熔断器:

额定工作电压(Ui) Volts: DC110V

额定工作电流(In) Amps: 分为两个结构尺码,至350Amax

使用类别: aR

时间常数 Time constant L/R: 3~5ms

分断能力 Breaking capacity(IR): 20kA;2.0In min

◆直流DC500V熔断器:

额定工作电压(Ui) Volts: DC500V

额定工作电流(In) Amps: 分为两个结构尺码,至250Amax

使用类别: aR

时间常数 Time constant L/R: 2±0.5ms

分断能力 Breaking capacity(I1/IR): 50kA;2.0In min

产品型号 Type	额定电压 Rated voltage (V)	额定电流 Rated current (A)	外形尺寸 Sizes(mm)								重量 Weight (g)
			A	B	C	φD	E	F	H	φd	
EV101-100	DC110	10,12,16,20, 25,32,40,50, 63,80,100	27.5	42	56	16.5	12.5	2.0	17.5	6.5×9	25
EV301-25	DC500	2,4,6,8,10, 12,16,20,25	39	54.5	67	10.3	10	0.6	11	5.5×7.5	12

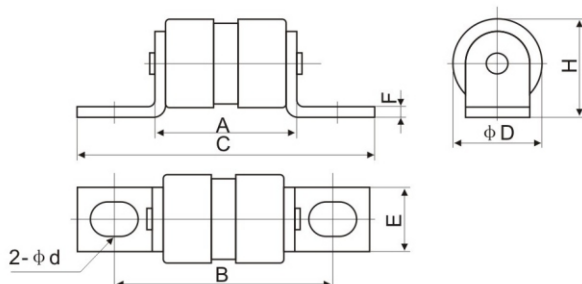

产品型号 Type	额定电压 Rated voltage (V)	额定电流 Rated current (A)	外形尺寸 Sizes(mm)								重量 Weight (g)
			A	B	C	φD	E	F	φd		
EV101-350	DC110	40,50,63,80, 100,125,160, 200,250,300, 315,350	70	52	32	28	22	5	8.2×12	98	
EV301-250	DC500	80,90,100, 125,160,180, 200,225,250	92	72	53	25	18	5	8.5×12	98	

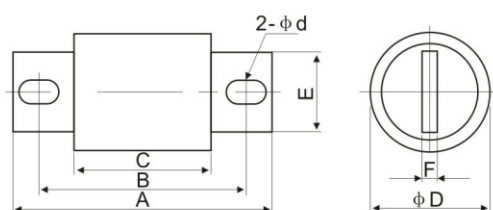

产品应用示意图 Product application diagram

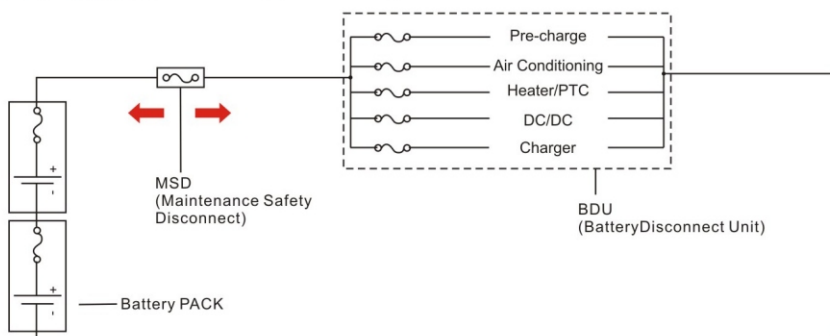

安装时螺钉拧紧力矩

螺钉规格	拧紧力矩
M4	2±0.5
M5	4.5±1
M6	6±1
M8	12±1